



Chaffey College

Established in 1883..... & now Serving
Chino, Chino Hills, Fontana, Montclair, Ontario, Rancho and Upland

310 Sq. Mile Area 3 Campus Locations 756,143 GSF



Ament Commercial Photography, 2014



DBIA Event

October 15, 2020



Chaffey College

Vision 2025 FMP - Measure P **\$700 Million Construction Bond Projects**

Proposed Projects - Phase I JULY 2019 - JUNE 2033

RANCHO CUCAMONGA CAMPUS			
PROJECT	Delivery Method	Start	Completion
<i>Library /Learning Commons</i>	<i>Design Build</i>	<i>September 2020</i>	<i>December 2024</i>
<i>Swing Space(Existing Library)</i>	<i>Design Bid Build</i>	<i>May 2023</i>	<i>September 2025</i>
<i>MACC Renovation /Addition</i>	<i>Design Bid Build</i>	<i>December 2020</i>	<i>September 2025</i>
<i>Automotive Technology (New)</i>	<i>Design Bid Build</i>	<i>April 2021</i>	<i>February 2026</i>
<i>Campus Center Building</i>	<i>Design Build</i>	<i>August 2024</i>	<i>February 2030</i>
<i>Instructional Building 1 (Rancho)</i>	<i>Design Build</i>	<i>November 2028</i>	<i>June 2033</i>
CHINO CAMPUS -COLLEGE PARK			
PROJECT	Delivery Method	Start	Completion
<i>Instructional Building 1 (Chino)</i>	<i>Design Bid Build</i>	<i>October 2019</i>	<i>December 2023</i>
<i>Main Instructional Building Renovation (Chino)</i>	<i>Design Bid Build</i>	<i>April 2022</i>	<i>August 2024</i>

DBIA Event

October 15, 2020



Chaffey College

Vision 2025 FMP - Measure P

\$700 Million Construction Bond Projects

Proposed Projects - Phase I (CONTINUED) JULY 2019 - JUNE 2033

FONTANA CAMPUS Expansion			
PROJECT	Delivery Method	Start	Completion
<i>Land Acquisition (Sierra Ave @ Underwood)</i>		<i>December 2019</i>	<i>March 2020</i>
<i>Campus Master Planning</i>		<i>September 2020</i>	<i>May 2021</i>
<i>Parking /Vehicular Circulation</i>	<i>Design Bid Build</i>	<i>July 2021</i>	<i>March 2024</i>
<i>Instructional Building 1</i>	<i>Design Build</i>	<i>July 2021</i>	<i>August 2026</i>
ONTARIO CAMPUS			
PROJECT	Delivery Method	Start	Completion
<i>Land Acquisition</i>		<i>March 2020</i>	<i>October 2021</i>

DBIA Event

October 15, 2020



Chaffey College

Please chat your questions!



DBIA Event

October 15, 2020

Riverside Community College District

DBIA Western Pacific Region

October 15, 2020

Bart Doering, Facilities Development Director



Capital Construction Plan

- \$350,000,000 - GO Bond - Passed in 2004
- \$163,000,000 - State Fund for Capital Outlay
- \$57,000,000 - Local Funding

\$570,000,000 (\$100,000,000 in the pipeline)



RCCD
RIVERSIDE
COMMUNITY
COLLEGE
DISTRICT

MORENO VALLEY

Ben Clark Training Center -
Education Building I - \$13 M (measure C)

Welcome Center - \$14 M (measure C)

NORCO COLLEGE

Veterans Resource Center - \$4.5 (State + Local)

Center for Human Performance & Kinesiology - \$35 M (State)

RIVERSIDE CITY COLLEGE

Life Science & Physical Science Reconstruction - \$35 M (measure C + State)

Engagement Center Renovation - \$5 M (local)

Student Services - \$5 M (measure C)

2020 FMPs Unified Projects List

Riverside City College (RCC)			Norco College (NC)			Moreno Valley College (MVC)		
No.	Project Name	Estimated Budget	No.	Project Name	Estimated Budget	No.	Project Name	Estimated Budget
1	Greenhouse - New - Measure C Funded (In Design)	\$ 500,000	1	Veteran Resources Center Phase 1 - New - Grant Funds (In Design)	\$ 3,762,259	1	BCTC Platform - State Grant + Measure C Funded (In Construction)	\$ 3,680,000
2	Physical & Life Science - Modernization- State FPP FY20/21 - (State/Measure C)	\$ 35,201,000	2	ACADEMIC Village - New	\$ 11,757,600	2	Welcome Center New - Measure C Funded (At DSA)	\$ 14,200,000
3	Digital Library (STEM) - Modernization	\$ 5,777,178	3	STEM Phase 1 - New	\$ 49,798,000	3	BCTC Education Center Building I - New - Measure C (In Design)	\$ 14,712,341
4	Advanced Technology (Applied Technology) + Central Plant - New	\$ 133,115,531	4	Early Childhood Education Center - New	\$ 11,124,475	4	Library/Learning Resource Center - New - FPP 2019 Submission	\$ 74,273,760
5	Visual Arts Complex (Phase I) - New	\$ 48,654,943	5	Reconstruct Applied Technology Education Center/Information Technology (ATEC/IT)	\$ 23,386,500	5	Student Services - Reconstruction New - Measure C + Others (In Planning)	\$ 8,973,460
6	Parking Structure - New	\$ 67,500,000	6	Kinesiology/ Athletics (Phase II) - New - FPP 2019 Submission	\$ 37,635,840	6	Biological & Physical Sciences (STEM) - New - FPP 2020 Submission	\$ 46,639,584
7	Stadium Complex (Fields Support, Cutter Pool, Sand Volleyball, Tennis Courts)	\$ 51,723,021	7	Softball Complex - New	\$ 7,259,598	7	Kinesiology and Athletics - New	\$ 48,754,500
8	Performing Arts Complex (Phase II) - New	\$ 94,859,865	8	Welcome Center/Student Services - New	\$ 29,189,340	8	Campus Safety & Operations - New	\$ 25,895,625
9	Cosmetology - New (Replacement of Existing) - FPP 2020 Submission	\$ 27,642,706	9	Library Learning Resource Center New + Student Center Reconstruction - FPP 2020 Submission	\$ 63,098,064	9	BCTC Education Center Building (Phase II) - New	\$ 47,985,000
10	Martin Luther King - Modernization	\$ 35,000,000	10	Parking Structure with Liner Building - New	\$ 54,794,880	10	Reconstruction of Existing Library - New	\$ 15,718,005
11	Kinesiology - New	\$ 50,772,204	11	Science + Technology & Humanities Reconstruction - Modernization	\$ 10,470,240	11	Reconstruction of Existing Humanities - New	\$ 35,531,250
12	Student Center - New	\$ 73,373,291	12	STEM Phase 2 - New	\$ 46,229,196	12	Reconstruction of Existing Science and Technology - New	\$ 16,313,040
13	Campus Police Facility - New	\$ 12,500,000	13	Social and Behavioral Sciences Phase 1 - New	\$ 26,742,144	13	Fine and Performing Arts Complex - New	\$ 36,629,334
14	Facilities Complex (Emergency Operation Center & Support Facilities) - New	\$ 11,000,000	14	Business / Classrooms - New	\$ 27,945,138	14	Parking Structure with Liner Building - New	\$ 77,532,000
15	Campus Signage	\$ 2,500,000	15	Parking Structure with Liner Building - New	\$ 61,855,794	15	Student Academic Services (SAS) Partial Renovation - Modernization	\$ 7,852,010
16	Bradshaw (renovate for instruction)	\$ 5,000,000	16	Operations and Maintenance Building - New	\$ 9,572,212	16	Career Technology Education (CTE)/Allied Health Complex - New	\$ 45,179,876
17	Infrastructure - Distributed Central Plant 01 - Existing Upgrade	\$ 23,088,623	17	Fine and Performing Arts Precinct - New	\$ 55,807,920	17	Early Childhood Education Center - New	\$ 8,351,385
18	Infrastructure - Distributed Central Plant 02 - New	\$ 42,858,178	18	Parking Structure with Liner Building - New	\$ 89,269,320	18	Early College High School & Parking Structure - New	\$ 115,626,000
19	Infrastructure - Distributed Central Plant 03 - New	\$ 26,990,374	19	Arts and Humanities Expansion Building - New	\$ 88,733,138	19	Student Center - New	\$ 24,763,200
20	Infrastructure - Phase 01 - 03 Site Civil (gas, water, sewer, etc.) Improvements	\$ 20,875,000	20	STEM Phase 3 - New	\$ 60,583,824	20	Infrastructure - Campus Wide Hot/Chilled Water Loop Infrastructure Project Phase 1	\$ 7,048,800
			21	Social and Behavioral Sciences Phase 2 - New	\$ 22,643,712	21	Infrastructure - Campus Wide Hot/Chilled Water Loop Infrastructure Project Phase 3	\$ 4,174,350
			22	Kinesiology + Track (Phase 2) - New	\$ 51,688,788	22	Infrastructure - Phase 01 Campus Wide Electrical Infrastructure Upgrades	\$ 5,211,600
			23	Veterans Resources Center (Phase 2) - New	\$ 19,771,043	23	Infrastructure - Electrical Upgrades 01 - 12KV/480 Volt Transformer	\$ 302,400
			24	Community + Student Center - New	\$ 32,819,069	24	Infrastructure - Electrical Upgrades 02 - 12KV/480 Volt Transformer	\$ 150,000
			25	Infrastructure - Campus Entry - Market Street Roadway Connector Upgrade	\$ 1,441,440	25	Infrastructure - Electrical Upgrades 03 - 12KV/480 Volt Transformer	\$ 234,000
			26	Infrastructure - Campus Entry - Lampton Roadway Upgrade, Connect ECC to STEM	\$ 1,170,000	26	Infrastructure - Electrical Upgrades 04 - 12KV/480 Volt Transformer	\$ 403,200
			27	Infrastructure - Campus Wide Hot/Chilled Water Loop Infrastructure Project Phase 1	\$ 11,040,300	27	Infrastructure - Phase 01 - 04 Site Civil (gas, water, sewer, etc.) Improvements	\$ 16,500,000
			28	Infrastructure - Campus Wide Hot/Chilled Water Loop Infrastructure Project Phase 2	\$ 3,192,719			
			29	Infrastructure - Campus Wide Electrical Infrastructure Upgrade, Phase 01	\$ 4,844,400			
			30	Infrastructure - Electrical Upgrades 01 - 12KV/480 Volt Transformer	\$ 532,800			
			31	Infrastructure - Electrical Upgrades 02 - 12KV/480 Volt Transformer	\$ 382,200			
			32	Infrastructure - Electrical Upgrades 03 - 12KV/480 Volt Transformer	\$ 832,200			
			33	Infrastructure - Phase 01 to 03 Site Civil (gas, water, sewer, etc.) Improvements	\$ 16,500,000			
RCC Total FMP Projects List		\$ 768,931,914	NC Total FMP Projects List		\$ 935,874,153	MVC Total FMP Projects List		\$ 702,634,720

MVC BCTC Education Center I

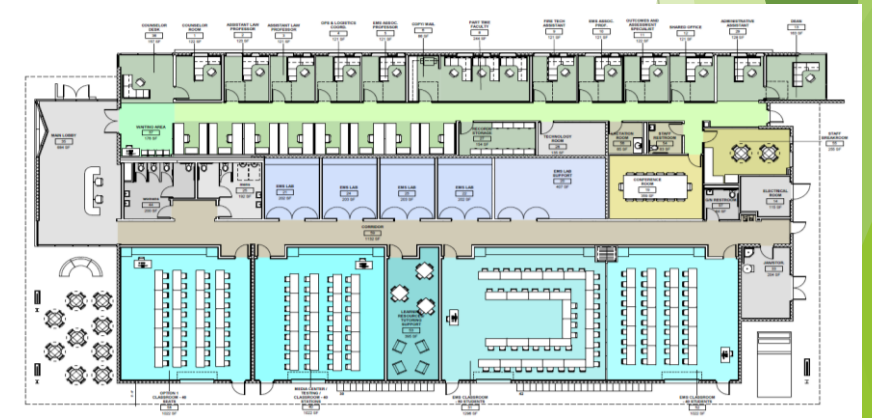

RCC Life & Physical Science



DESCRIPTION	LEVEL 1 ASF	LEVEL 2 ASF	ASF TOTAL
CLASSROOM	3,926 SF	4,913 SF	8839 SF
CLASS LAB	1,996 SF	6,943 SF	8939 SF
CLASS LAB SERVICE/ TESTING	499 SF	(HOWE THE FLOOR)	499 SF
OFFICE/ OFFICE SERVICE	3,960 SF	(HOWE THE FLOOR)	3960 SF
CONFERENCE ROOM	288 SF	330 SF	618 SF
READ/ STUDY	(HOWE THE FLOOR)	1,000 SF	1000 SF
AUDIO/ VISUAL (NOC/ SOC)	(HOWE THE FLOOR)	1,764 SF	1764 SF
MEETING ROOM	4,531 SF	426 SF	4957 SF
DATA PROCESS (DISTANCE LEARNING + IDF)	289 SF	2,291 SF	2580 SF
LOUNGE + LOUNGE SERVICES	(HOWE THE FLOOR)	699 SF	699 SF
	15,480 SF	10,566 SF	34,055 SF

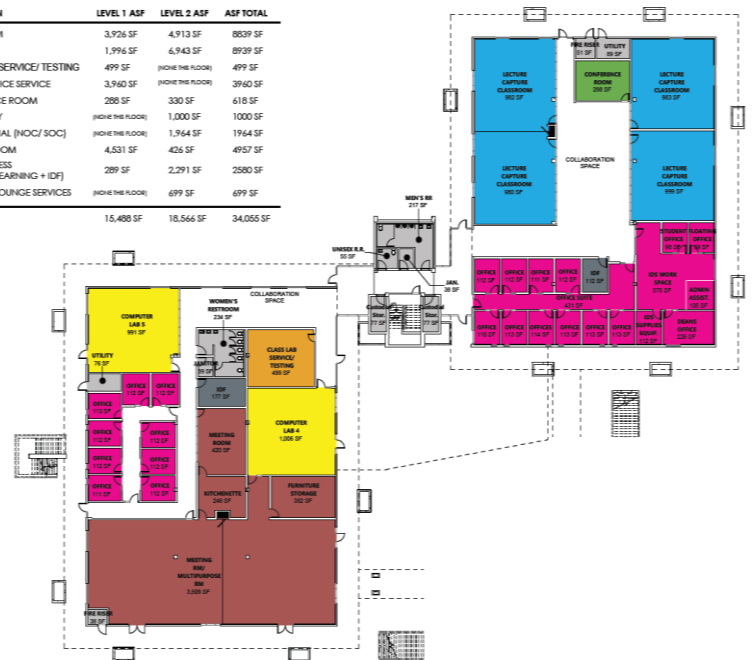



SOUTH ORANGE COUNTY COMMUNITY COLLEGE DISTRICT
SADDLEBACK COLLEGE ♦ IRVINE VALLEY COLLEGE ♦ ATEP

South Orange County Community College District (SOCCCD)

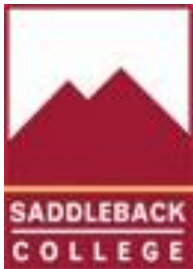

Half Century of Excellence!

First established in 1967 as Saddleback College, it has now grown into a multi-college district comprised of Saddleback College in Mission Viejo, Irvine Valley College (IVC) in Irvine, and the Advanced Technology & Education Park (ATEP) in Tustin. Both colleges are accredited institutions that prepare students for associate degrees, transfer to four-year colleges and universities, workforce development, basic skills, and lifelong learning.



SOUTH ORANGE COUNTY COMMUNITY COLLEGE DISTRICT
SADDLEBACK COLLEGE ♦ IRVINE VALLEY COLLEGE ♦ ATEP



Capital Outlay Program Updates October 15, 2020

Presented by:

**Nawar Al Juburi, CCM, LEED G.A.
Senior Project Manager, Lead District Liaison - DSA
Facilities Planning Department**





SOUTH ORANGE COUNTY COMMUNITY COLLEGE DISTRICT

SADDLEBACK COLLEGE ♦ IRVINE VALLEY COLLEGE ♦ ATEP

Saddleback College Projects List

1- Upcoming Construction Projects (Design/DSA):

- New Gateway Building
- ATEP – Culinary / Auto Tech Building
- Districtwide ADA Improvements
- ATAS Building & Tennis Center (Under Construction)
- Saddleback Stadium (Under Construction)

2- Upcoming Design Projects (New Buildings):

- Science & Math (SM) Replacement (FPP)
- PE Complex Replacement (IPP)
- Student Union & Parking Structure
- Student Housing Development
- Solar Canopy Project – Multi Phases
- Main Quad Extension + Pedestrian Bridges
- New Wellness Center + Volleyball
- Parking Structure (Lot #10)

3- Upcoming Design Projects (Building Renovation):

- Fine Arts Complex (IPP)
- TAS Renovation / Campus Support Center (FPP)
- Softball + Lot 12 Expansion
- Villages Demolition Phases
- M&O Grounds + Transpiration

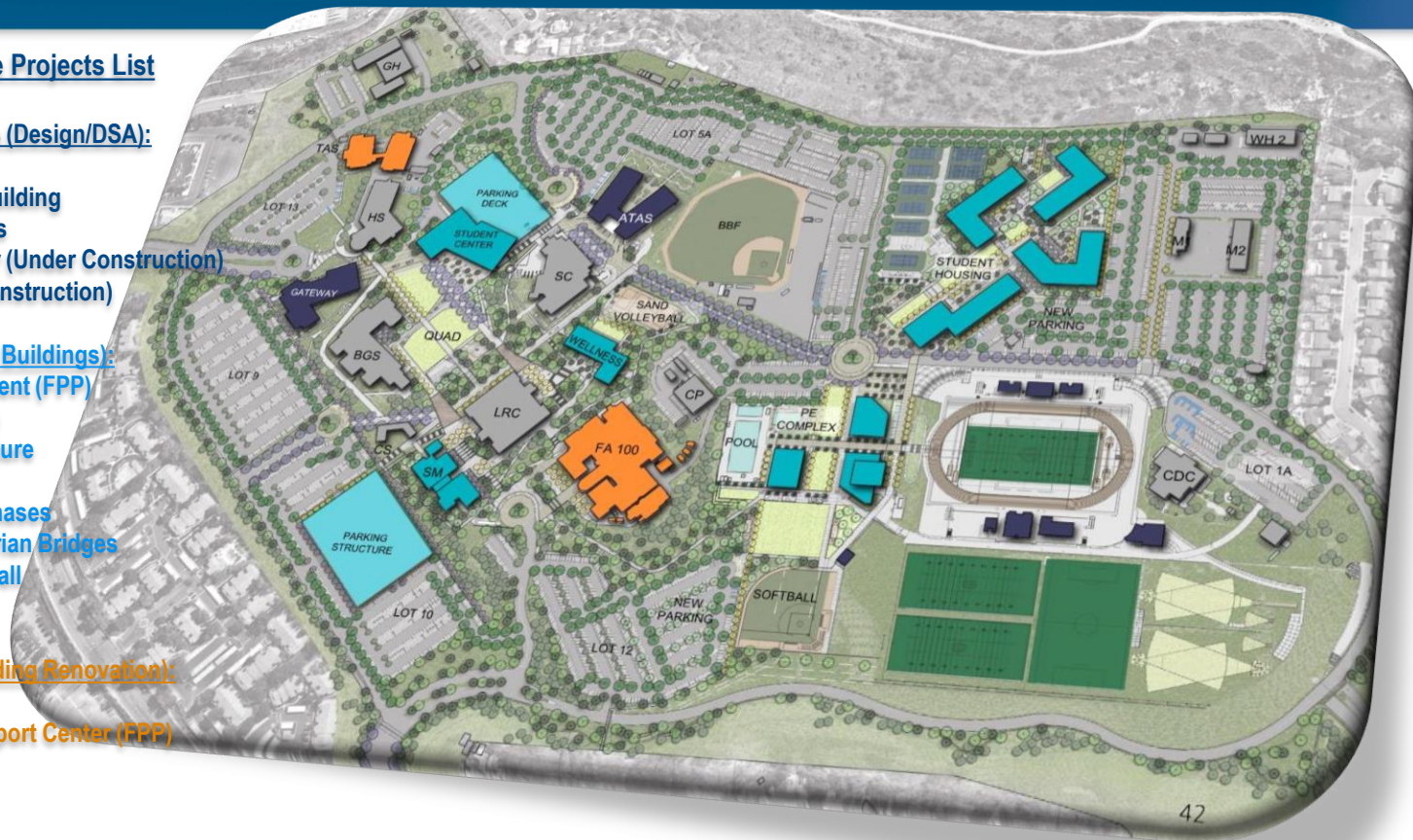



SOUTH ORANGE COUNTY COMMUNITY COLLEGE DISTRICT

SADDLEBACK COLLEGE ♦ IRVINE VALLEY COLLEGE ♦ ATEP

Irvine Valley College (IVC) Projects List

1- Upcoming Construction Projects (Design/DSA):

- New Fine Arts Complex
- New Student Services & Student Union
- New Soccer & Multipurpose Athletics Fields
- Districtwide ADA Improvements

2- Upcoming Design Projects (New Buildings):

- Administration Building
- Instructional Building (IPP)
- PE 100 & Wellness Court
- Parking Lot Reconfiguration & Solar Canopies (Lot 1 thru 4)
- Fine Arts Promenade Landscape /Hardscape

3- Upcoming Design Projects (Building Renovation):

- Library Renovation
- Quads Renovation (Main Quad & A Quad)
- Campus Police & IT
- B-200 Improvements- Multiple Phases
- B-300 (FPP)
- PE 200 (IPP)
- M&O Complex





Design Build Project update

Representing San Bernardino Community College

Farrah Farzaneh

Director, Facility Planning, Emergency Management &
Construction

Julio Palacio

Measure CC Bond Program Manager



Who is SBCCCD?

- 1 Out of 73 Community College
- Districts in State of California
- 2 Out of 115 Campuses of
- CCD system
- 4 Million people within its
- geographical region
- 22 Cities and Communities within
- its geographical region
- 25,000 students served annually
- 1 Million square-feet and 57
- facilities district-wide
- \$621,800,000 Dollar contribution annually
- for regional economic impact



Upcoming Progressive DB Projects:

SBVC:

Instructional & Student Services Building- \$80.6M

Career Pathways 2 - \$70.1M

CHC:

Central Complex 2 Renovation-\$13M

EV Public Safety Training - \$7.2M

Instructional Building (East) \$42.2M+

\$7.2M (Cost of Existing PAC Demo)

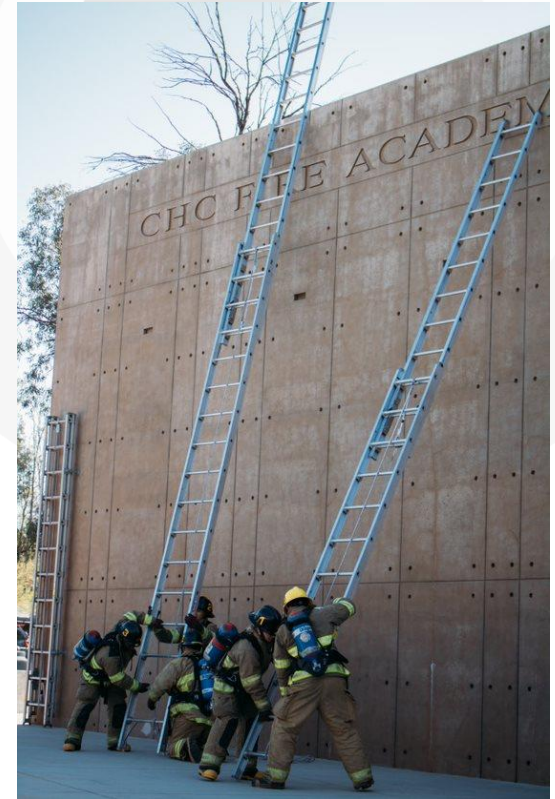

Campus-Wide Infrastructure Projects

Anticipated projects:

- Security Upgrades: In scope development
- Utility Metering: In scope development
- SBVC Planetarium HVAC Upgrades: Feasibility study
- CHC Parking Lot Pavement Improvements: In scope development
- CHC Central Plant Expansion: In scope development
- CHC Irrigation Upgrade: In design
- CHC Exterior Lighting Upgrades: In Construction



Thank you!

